



- The control unit for DIN-rail mounting allows easy adjustment
- The sensor unit for wall-mounting (923 500) or mounting within housing (923 501) is included in delivery
- Two adjustment ranges
1–100 / 50–1,000 Lux
- Time delay approx. 8 sec. when switching ON and approx. 40 sec. when switching OFF
- Switching OFF value is approx. 1.3 times the value of switching ON
- While setting the Lux-value the diode lights up if Lux-value corresponds to the current light intensity
- Zero-cross switching for relay-saving switching

Illuminate

switching controlling counting

Twilight switches 923 500 / 923 501 for DIN-rail mounting



Technical data

Supply voltages	230 V, 50 Hz
Power consumption (real power)	0,5 W
Channel	Normally open
Switching capacity	16 A / 250 V- at $\cos\phi=1$ 4 A with inductive load $\cos\phi=0,6$
Zero-cross switching	Yes / for relay-saving switching
Contact material	AgSnO ₂
Filament Lamp Halogen Lamp	3,000 W
Fluorescent Lamp uncompensated	3,600 W
Fluorescent Lamp parallel compensated (130 μF)	1,300 W
Compact Fluorescent Lamp	18 x 7 W, 12 x 11 W, 10 x 15 W, 10 x 20 W, 10 x 23 W max.
Switching-On value	1–100 / 50–1,000 Lux
Time delay	approx. 8 sec. at ON, approx. 40 sec. at OFF
Switch-off	approx. 1.3 times the value of switching ON
Mounting	35 mm DIN-rail
Permitted ambient temperature	Sensor unit –35°...+50°C Control unit –10°...+40°C
Type of protection	IP 54 for sensor 923500, IP 65 for sensor 923501, control unit IP 20
Sensor wiring, cross section	min. 0.5 mm ²

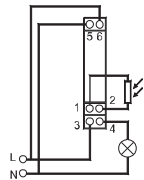
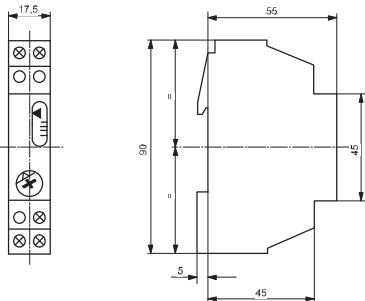

Order number	Switching contacts	Version
paladin 923 500	1	sensor for wall mounting
paladin 923 501	1	sensor for mounting within housing

▾ Housing colour